

Jalapeno How To - *Create a value stream*

Where do I find value streams in Jalapeno?

Value streams can be found within the Business Architecture module of Jalapeno. After selecting the “Value Stream” menu item make sure to select the root item of the tree and click on the ‘Model’ tab.

How do I add value streams to the value stream tree?

Value streams may be added individually via the tree. Click on the  button in Jalapeno to create a new value stream.

To better understand how to use and manage trees within Jalapeno, view this [guide](#).
To learn how to add and edit items within Jalapeno trees, view this [guide](#).

How do I add value stream stages to the value stream?

Value stream stages may be added individually or via bulk import. When you click on a selected value stream in the tree, click on the ‘Model’ tab and the ‘Construct Stages’ sub-tab to view the value stream stage table. Click on the  icon to start adding stage information and its relationships.

How do I relate additional information to each value stream?

When you click on a selected value stream within the tree, navigate to the ‘Model’ tab and the ‘Model Relations’ sub-tab. Here you will find a variety of properties that can be associated with the value stream. You can align the value stream to other areas of Jalapeno that have already been modelled.

To better understand how to use this input page, view this [guide](#).
To better understand how to relate existing items within Jalapeno, view this [guide](#).

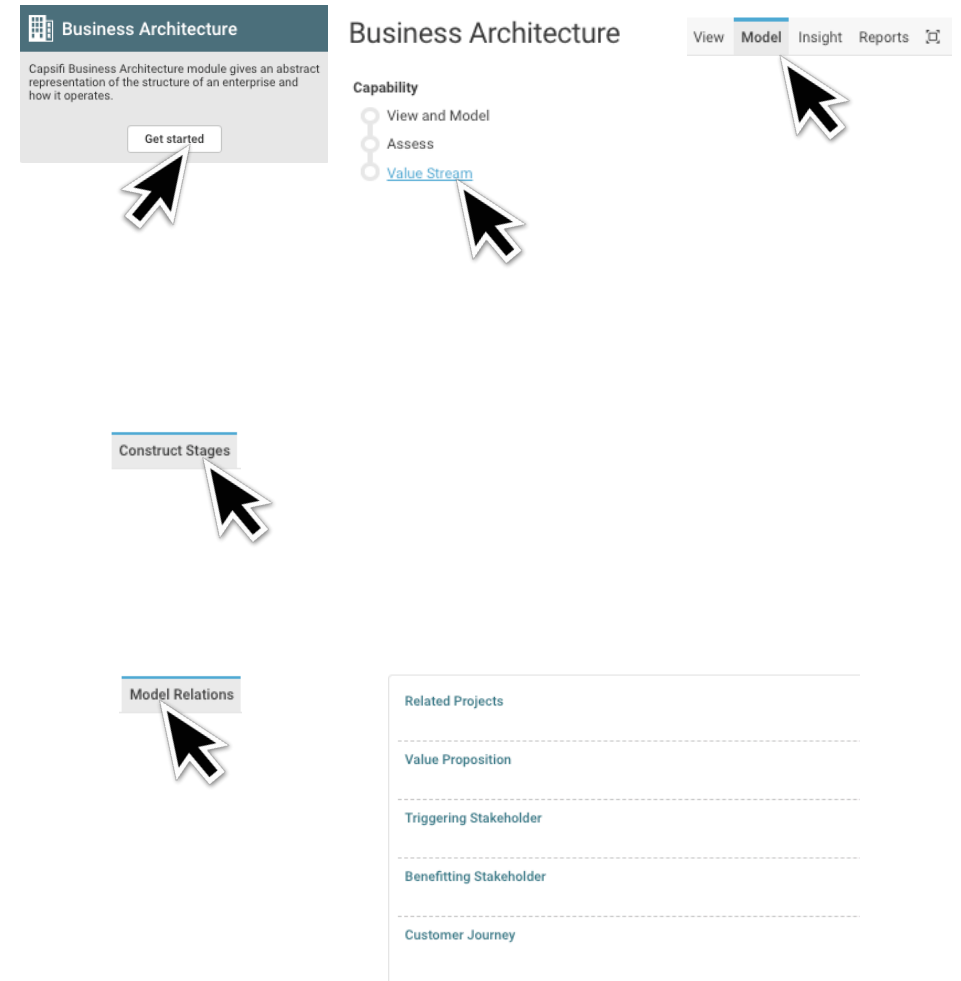

What are the essential parts of a value stream that need to be modelled?

There is very little in Jalapeno that is mandatory. You may model as little or as much as is needed. However, for value stream information to appear on the Activity Pathways, it needs to consist of value stream stages. These stages need to be aligned to relevant capabilities, entry/exit criteria and participating stakeholders.

To learn more about creating a capability, view this [guide](#).

To learn more about creating a stakeholder, view this [guide](#).

To learn more about creating an entry/exit criteria, view this [guide](#).

To gain a better insight from a value stream, it needs to be aligned to a metric.

To learn more about creating a metric, view this [guide](#).

You may come back and align capabilities, entry/exit criteria, stakeholders or metrics if you do not already have this information modelled in your Jalapeno model.

